

Standing seam requirements

Panel size Standing seam roof panels can be up to 600mm wide, with 530mm and 430mm wide panels also being standard (non standard widths less than 600mm but greater than 150mm are also possible). Zinc, at 0.7mm thick, is the standard roofing thickness. However, for long panels or exposed sites 0.8mm thick zinc should be considered. Standing seam panels for wall cladding should be no wider than 430mm and should use 0.8mm thick zinc. Using wider, thinner panels will result in the cladding being less flat. We would also recommend that vertical panels be no more than 4m in length.

Minimum slope The minimum slope for standing seam roofing as built is 3° (5%). It is possible to cover barrel shaped roofs with a panel that runs continuously across the apex of the roof. Any zinc surface that is wider than 500mm should be considered as roofing and therefore the 3° minimum would be applicable. Below this width, for flashings such as parapets, the slope can be reduced to 1°. It is important to remember that the correct detail must be used at the correct roof slope.

Noise As zinc is a relatively soft metal, impact noise is rarely an issue. However, if the building owner does have concerns the use of a warm roof build-up would reduce not only impact noise but also possible noise created by pressure differences in a vented air space which is a prerequisite of a vented roof.

VMZINC and VMZINC PLUS Zinc is a metal that has been used to clad the exterior of buildings for many years and as such is resistant to water. However, this is only the case in the presence of carbon dioxide (which is present in air). If zinc is installed on a substrate that limits the amount of air that can be in contact with its back surface it is possible that this will induce the formation of white rust. It is for this reason that VMZINC (no backside coating) can only be used on roofing and cladding when vented open gap softwood boarding is used as a substrate. VMZINC is also acceptable on vented rainscreen facades. For all other roof build-ups VMZINC PLUS must be used.

VMZINC PLUS consists of VMZINC (in all finishes including AZENGAR) having a 60µm coating applied to the underside thus allowing a more varied amount of substrates to be used and eliminating the risk of the formation of white rust on the underside of the zinc standing seam panels. VMZINC PLUS resists to an abrasion of 40 litres when tested in accordance with ASTM D 968.



Material suitability

Product	Structural roof	Compact roof	Metdeck roof	Metal-faced panel	Vented plywood	Vented softwood boarding	Vented rainscreen facade
VMZINC	No	No	No	No	No	Yes	Yes
VMZINC PLUS	Yes	Yes	Yes	Yes	Yes	Yes	Yes

Standing seam requirements

Fixing clip types, location and spacing

All standing seam panels must have a fixed area of at least 5 fixed clips which do not allow any thermal expansion or contraction. It should be noted that when items such as PV panels or snow retention systems are being fitted directly to the zinc roof a calculation of shear load must be carried out. This will determine whether by increasing the number of fixed clips will be sufficient or not to deal with the possible shear loads. Maximum clip spacing is 330mm (A) with this reducing to 200mm (B) along the edges of the roof (at least 1100mm or 1/8 of the projected roof) and 150mm (C) where two edges meet.



Sliding clip

Fixed clip

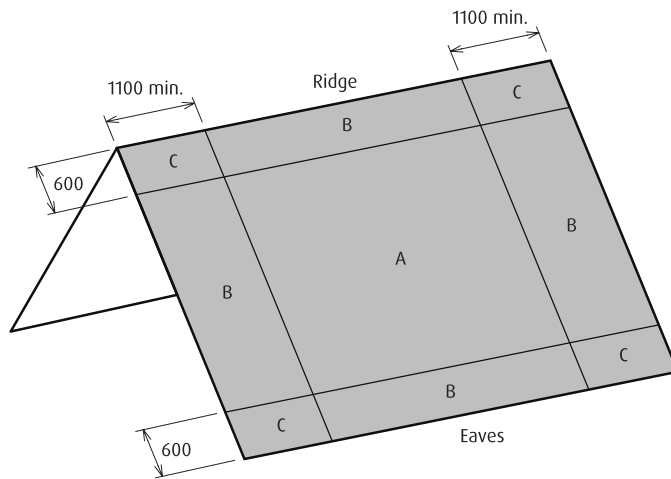

Sliding clip:

Sliding piece should be central during installation

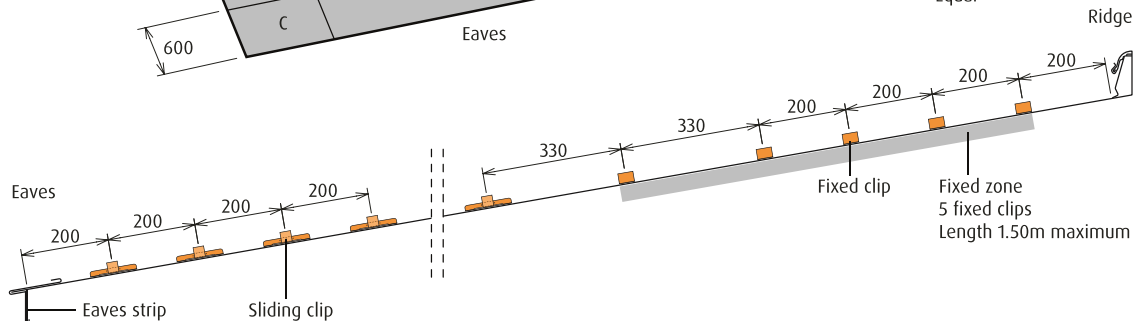
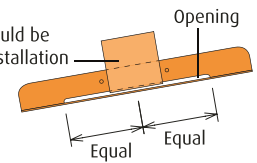

The normal zone for fixed clips is at the top of the roof panel (above). For panels of length between 10m and 13m it is advisable to move the fixed zone down the roof panel (as shown on the right).

For slopes exceeding 30°, maximum panel length should be 10m.

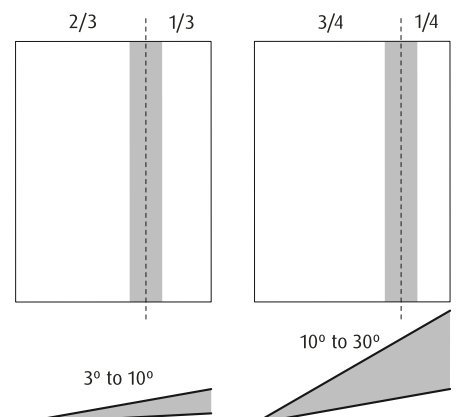

All dimensions in mm